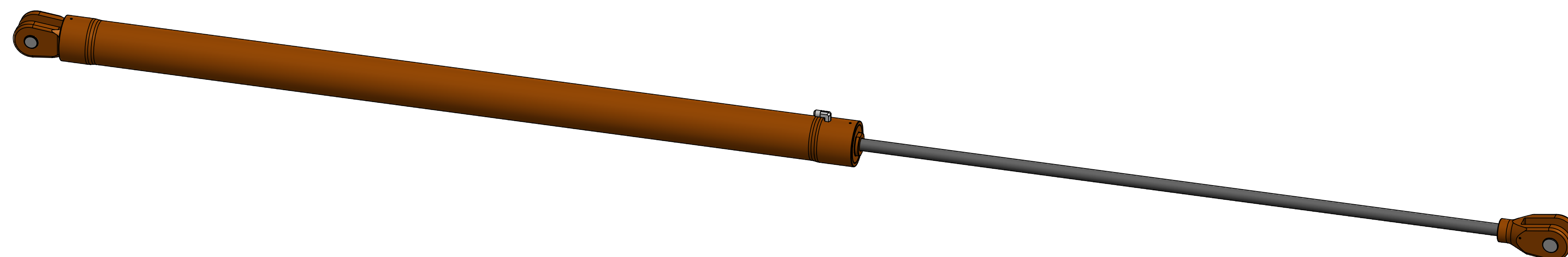

<i>Function</i>	Single acting cylinder - gas spring	
<i>Bore</i>	60	mm
<i>Stroke</i>	1100	mm
<i>Pull load @ 350 bar (max pressure)</i>	8967	kg
<i>Pull load @ 250 bar</i>	6405	kg
<i>Pull load @ 200 bar</i>	5124	kg
<i>Approx. dry weight</i>	11,6	kg
<i>Max oil volume</i>	2,76	l

[illegible]