

Function	Single acting cylinder - gas spring	
Bore	40	mm
Stroke	600	mm
Pull load @ 350 bar (max pressure)	3766	kg
Pull load @ 250 bar	2690	kg
Pull load @ 200 bar	2152	kg
Approx. dry weight	3,7	kg
Max oil volume	0,63	l

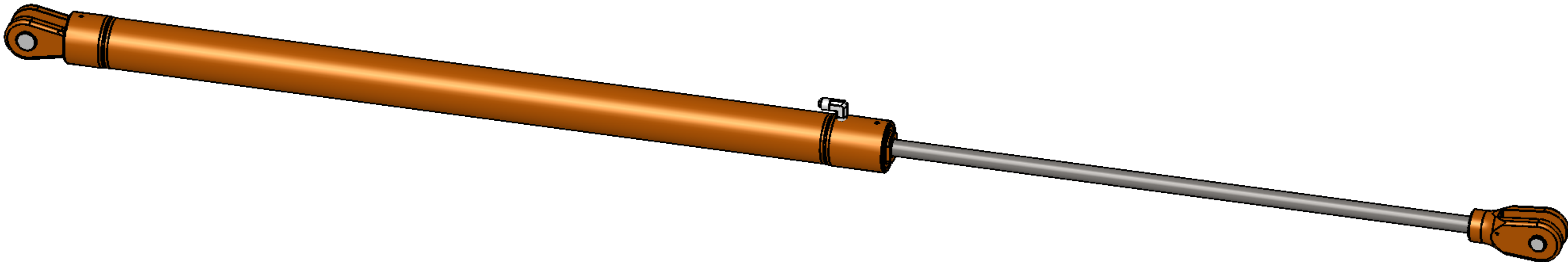

REV.	DATA / DATE	DESCRIZIONE / DESCRIPTION	NOME / NAME
RIFERIMENTO / REFERENCE			TABLE
TRAT. TERMICO / HEAT TREAT.		TRAT. SUPERFICIALE / FINISH	SIZE
CONTROLLATO / CHECKED	DATA / DATE	MATERIALE / MATERIAL	A1
AC	30/11/2017		
APPROVATO / APPROVED	DATA / DATE	SCALA / SCALE	PESO / WEIGHT kg
		1:3@A1	
DISEGNO N. / DRAWING		REV.	
		CL_040_S_0600 -	
DESCRIZIONE / DESCRIPTION			
EASY LINE - CL 40 SINGLE ACTING STROKE 600			

CARIBONI S.r.l.
Via Mattei 3/A
20885 Ronco Briantino
e-mail: info@cariboni-italy.it
www.cariboni-italy.com

Tel +39 039 6079609
fax +39 039 6079128

ATTENTION! THIS DOCUMENT AND THE INFORMATION IT CONTAINS SHALL NOT BE REPRODUCED NOR DISCLOSED TO ANYBODY, BECAUSE PROPERTY OF CARIBONI GIOVANI