



## VANGS

The hydraulic vang enable the mainsail leech tension to be trimmed to an extremely fine degree from the cockpit; they also provide boom lift in light air conditions, when furling, reefing or flacking.

Hi-tech materials and advanced design for top performance, reliability and lightweight. Black hard coated aluminium for cylinder tube and terminals, Nitronic 50 stainless steel for piston rod and 17-4-PH stainless steel for pins. For the safety of the yacht, the vang can be instantaneously dumped using the **CARITEC** quick release valve.

SIZE	MODEL	Max Traction Load <sup>(1)</sup>		Max return force <sup>(2)</sup>		Stroke		Pin ø		F		G		Oil Volume liters	WEIGHT		
		kg	lb	kg	lb	mm	in	mm	in	mm	in	mm	in		W <sub>kg</sub> (3)	a	c
17	VNG 40	3127	6894	385	849	250	9.84	16.0	0.63	24.0	0.94	31.0	1.22	0.2	6	0.00204	1.7
20	VNG 50	4483	9883	601	1325	280	11.02	15.5	0.61	26.0	1.02	30.0	1.18	0.4	8	0.00303	2.9
24	VNG 60	7566	16679	866	1909	280	11.02	15.5	0.61	26.0	1.02	30.0	1.18	0.6	9	0.00303	3.7
30	VNG 70	10906	24043	1178	2598	300	11.81	19.0	0.75	29.5	1.16	41.0	1.61	0.9	14	0.00335	8.6
40	VNG 80	13450	29652	1539	3393	350	13.78	22.0	0.87	34.5	1.36	52.0	2.05	1.3	23	0.00511	11.6
60	VNG 90	18214	40154	1948	4294	360	14.17	25.0	0.98	36.0	1.42	56.0	2.20	1.8	31	0.00596	11.7
70	VNG 100	23538	51891	2404	5301	400	15.75	28.0	1.10	40.0	1.57	58.2	2.29	2.6	41	0.00681	22.9
90	VNG 110	26675	58806	2909	6415	430	16.93	31.8	1.25	49.0	1.93	64.0	2.52	3.2	54	0.00766	29.2
110	VNG 130	35517	78300	4063	8959	500	19.69	35.0	1.38	56.0	2.20	78.2	3.08	5.0	88	0.01290	51.9
260	VNG 165 (4)	58414	128779	DOUBLE ACTING		526	20.71	50.8	2.00	62.5	2.46	112.5	4.43	11.2	134	0.02384	51.1

(1) At 350 bar (5000 psi) and no gas pressure.

(2) At 30 bar (435 psi) gas pressure. Return force can vary from zero to twice the table force value, by varying the gas pressure.

(3) Weight for minimum length, please calculate the exact weight using the following formulas:

$$W_{kg} = (PCLC_{mm} \cdot a) + c \quad (PCLC \text{ is the vang Length pin to pin cylinder closed in mm}).$$

$$W_{lb} = W_{kg} \cdot 2.205$$

(4) With integrated position sensor inside the cylinder

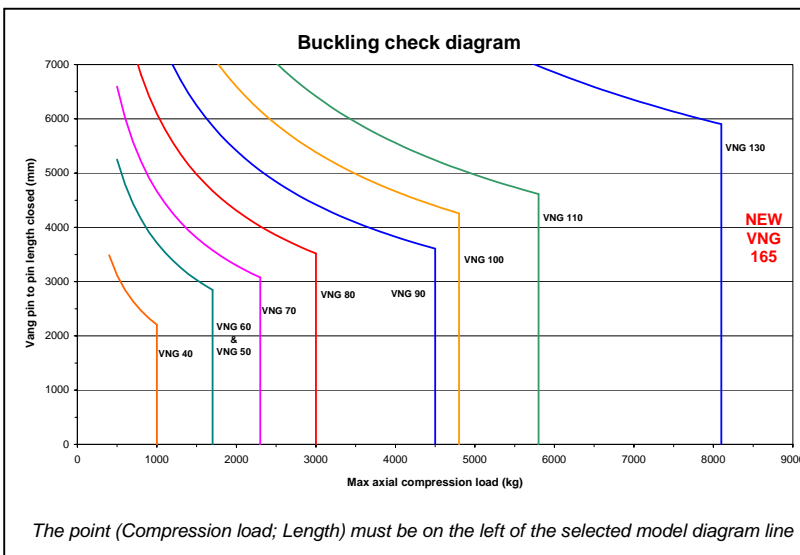
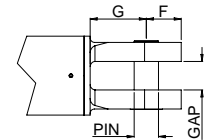

## MAST JACK

Mast jack for rigging preloads.  
17-4-PH stainless steel.  
10000 psi working pressure.  
To be driven by **CARITEC** single panel.

