

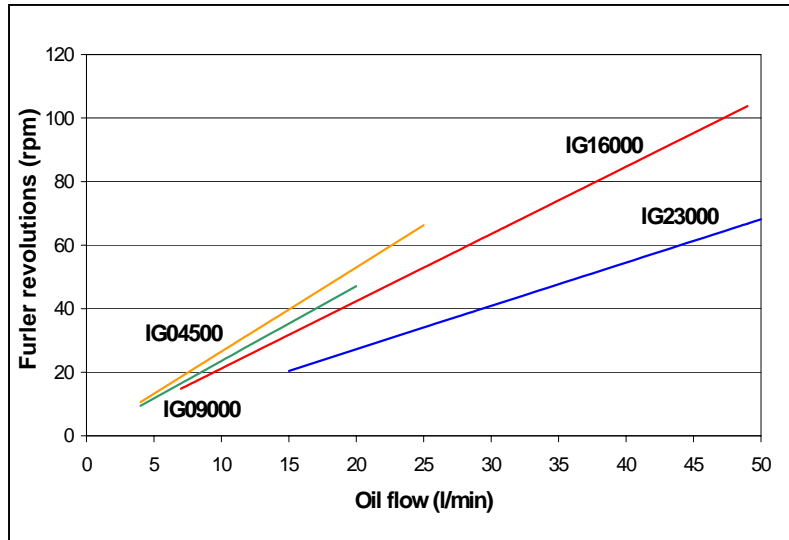

# HYDRAULIC CODE ZERO FURLERS

S-IG  
Rev. 9  
Pg. 1 of 3

MODEL	Max working load (traction)		Max oil pressure		Weight		Dimensions
	kg	lb	bar	psi	kg	lb	mm
<b>IG 04500</b>	4500	9921	140	2030	9.2	20.3	204x207x280
<b>IG 09000</b>	9000	19841	140	2030	16.7	36.8	204x207x280
<b>IG 16000</b>	16000	35273	400	5800	35.0	77.2	227x262x298
<b>IG 23000</b>	23000	50705	400	5800	67.8	149.5	303x331x368



IG 09000 with Giro 91P

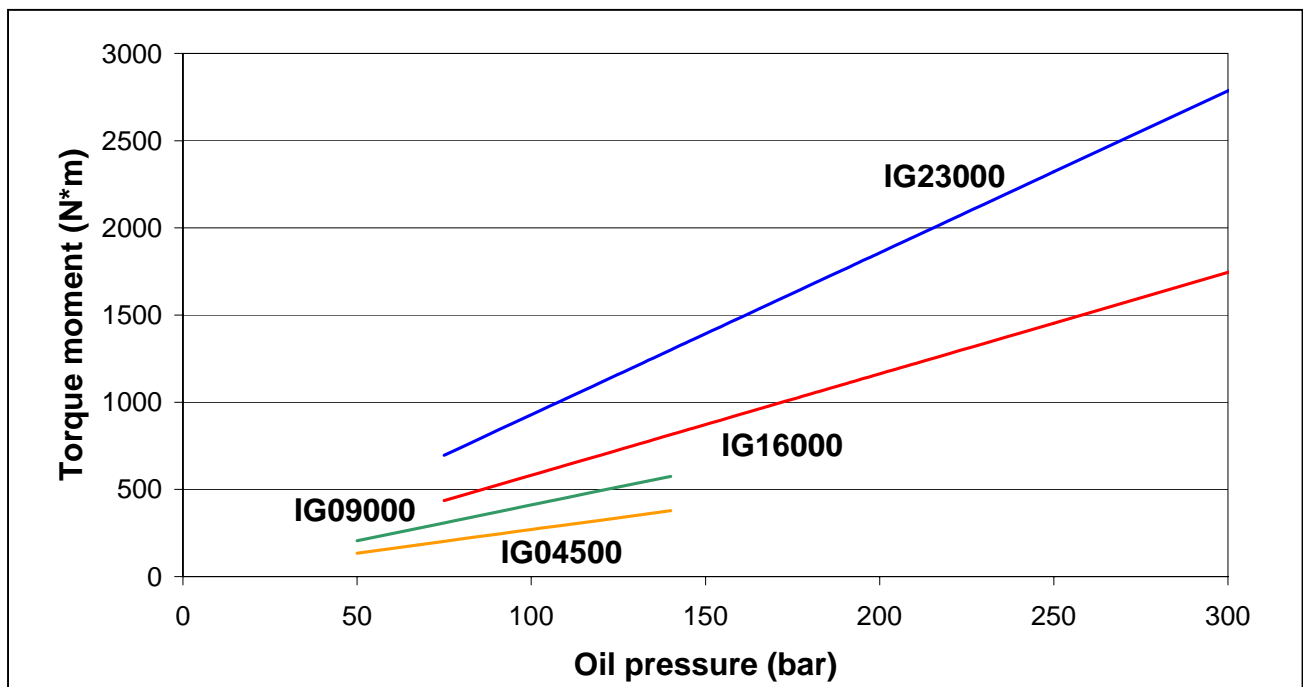

## FURLER MAIN DIMENSIONS

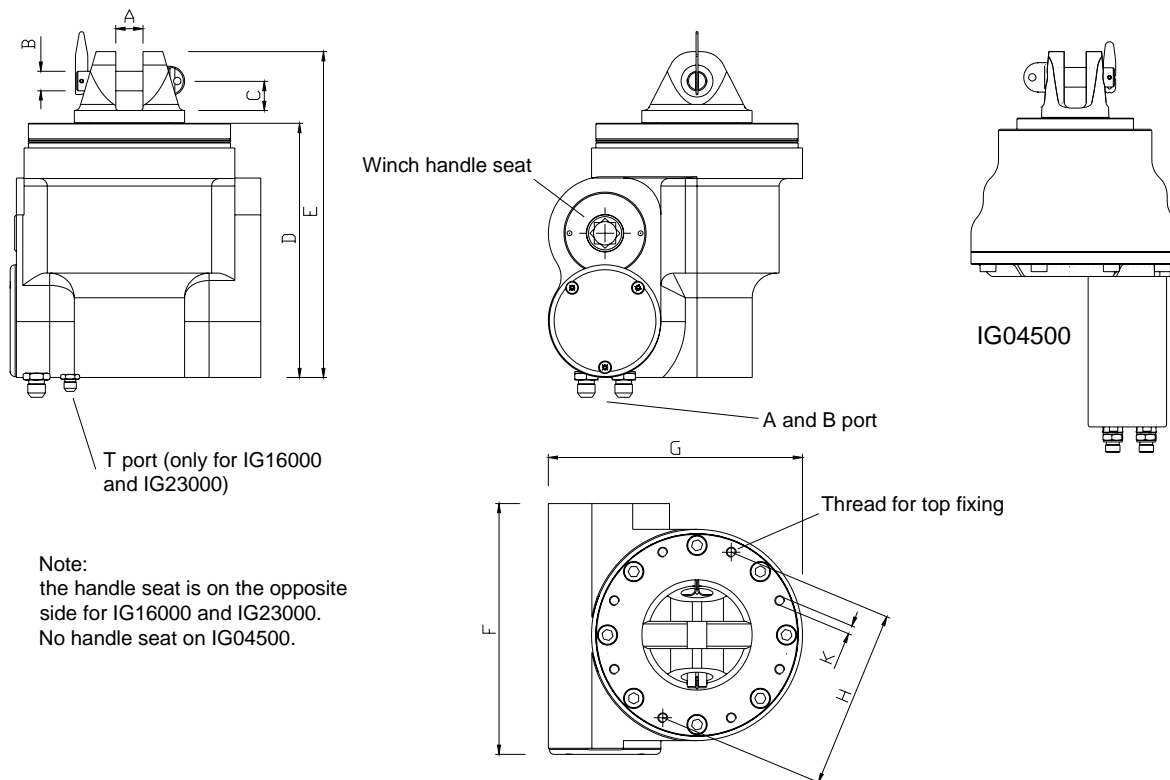

	IG 04500		IG 09000		IG 16000		IG 23000	
	mm	in	mm	in	mm	in	mm	in
<b>A</b>	18,00	0,71	22,10	0,87	24,00	0,94	30,00	1,18
<b>B</b>	16,00	0,63	16,00	0,63	22,00	0,87	28,00	1,10
<b>C</b>	25,00	0,98	24,00	0,94	38,70	1,52	50,00	1,97
<b>D</b>	129,00	5,08	206,97	8,15	217,81	8,58	257,20	10,13
<b>E</b>	183,25	7,21	280,47	11,04	299,50	11,79	269,70	10,62
<b>F</b>	170,00	6,69	204,30	8,04	227,30	8,95	303,05	11,93
<b>G</b>	170,00	6,69	207,25	8,16	261,57	10,30	331,13	13,04
<b>H</b>	110,00	4,33	146,00	5,75	150,00	5,91	240,00	9,45
<b>K threads</b>	n° 8 M8		n° 8 M8		n° 8 M8		n° 8 M10	
<b>A and B port</b>	9/16" UNF JIC 37°		9/16" UNF JIC 37°		9/16" UNF JIC 37°		9/16" UNF JIC 37°	
<b>T port</b>	-		-		7/16" UNF JIC 37°		7/16" UNF JIC 37°	

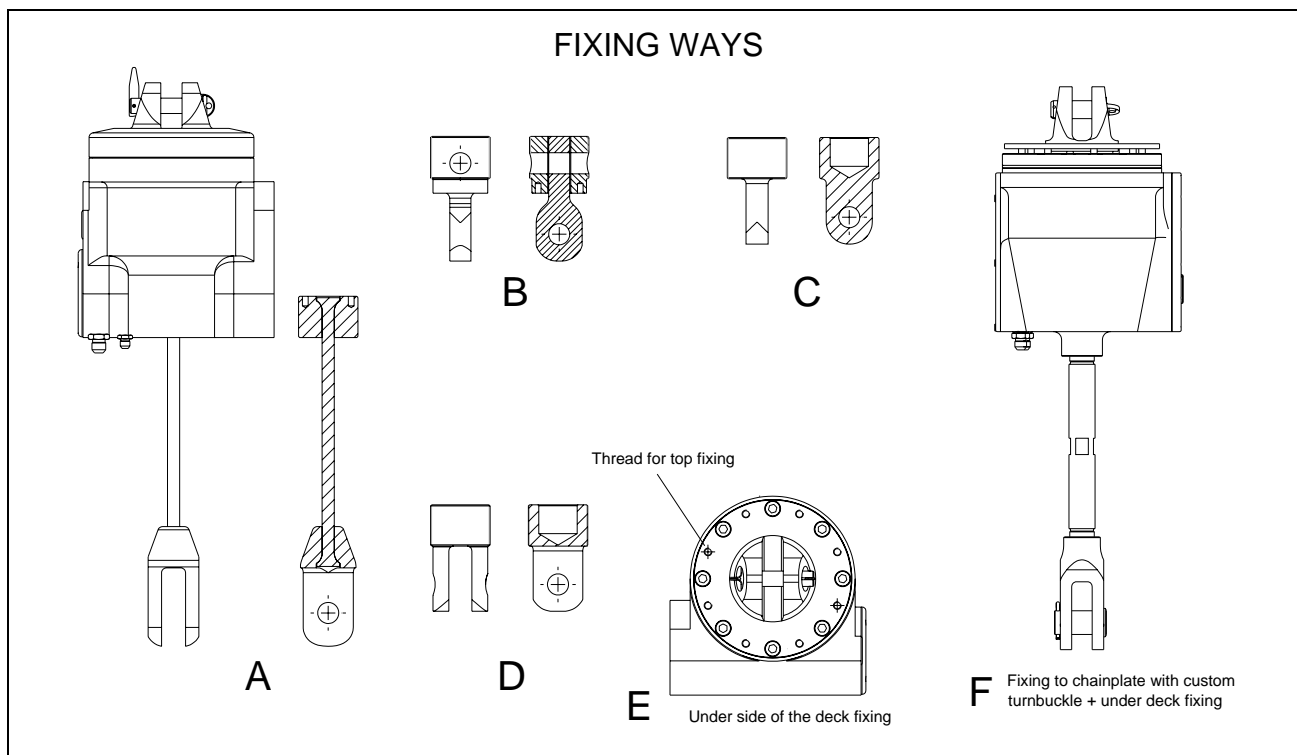

- Note:**
- All fixing systems but “E” and “F” need a box to support the furler weight. The box for system “A” must support also torque moment.
  - Max angle between furler axis and luff of the sail is 15°.

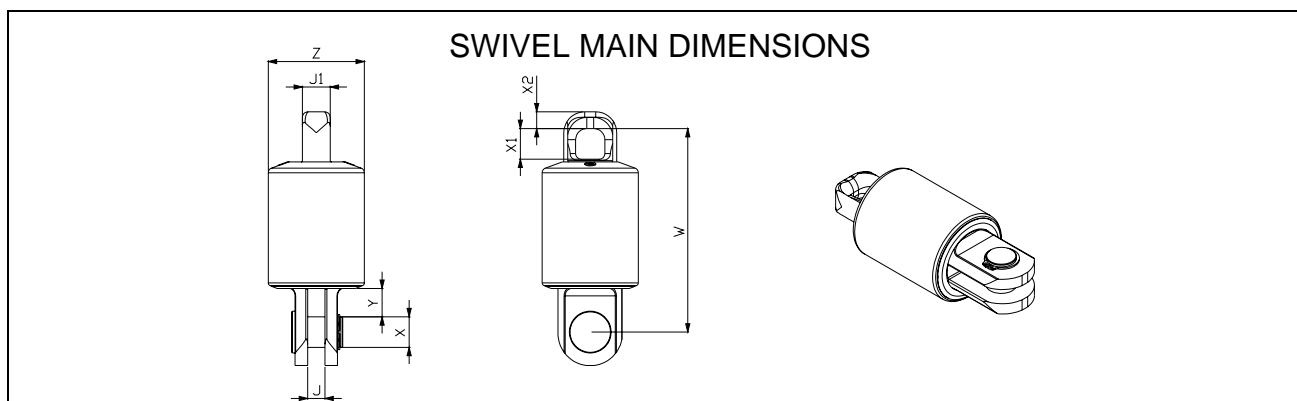

	<b>FST_05_045</b> <i>Titanium</i> , for IG 04500		<b>FST_06_4001</b> <i>Titanium</i> , for IG 09000		<b>FST_08_016</b> <i>Titanium</i> , for IG 16000		<b>FST_10_023</b> for IG 23000	
	mm	in	mm	in	mm	in	mm	in
<b>J</b>	10,00	0,39	12,50	0,49	18,00	0,71	30,00	1,18
<b>J1</b>	15,00	0,59	20,00	0,79	22,00	0,87	40,00	1,57
<b>W</b>	110,50	4,35	147,62	5,81	211,50	8,33	362,00	14,25
<b>X</b>	16,00	0,63	22,00	0,87	30,00	1,18	30,00	1,18
<b>X1</b>	20,00	0,79	23,50	0,93	27,50	1,08	50,38	1,98
<b>X2</b>	10,50	0,41	10,50	0,41	13,50	0,53	32,00	1,26
<b>Y</b>	10,00	0,39	20,35	0,80	30,00	1,18	40,00	1,57
<b>Z</b>	61,00	2,40	69,10	2,72	105,00	4,13	180,00	7,09
<b>Weight</b>	1,0 kg	2,2 lb	1.4 kg	3.1 lb	3.9 kg	8.6 lb	41,8 kg	92,2 lb